



CHIRICAHUA

COMMUNITY HEALTH CENTERS, INC.

HEALTH FOR ALL

Thank You For
Being Great Patients
We
Appreciate
You

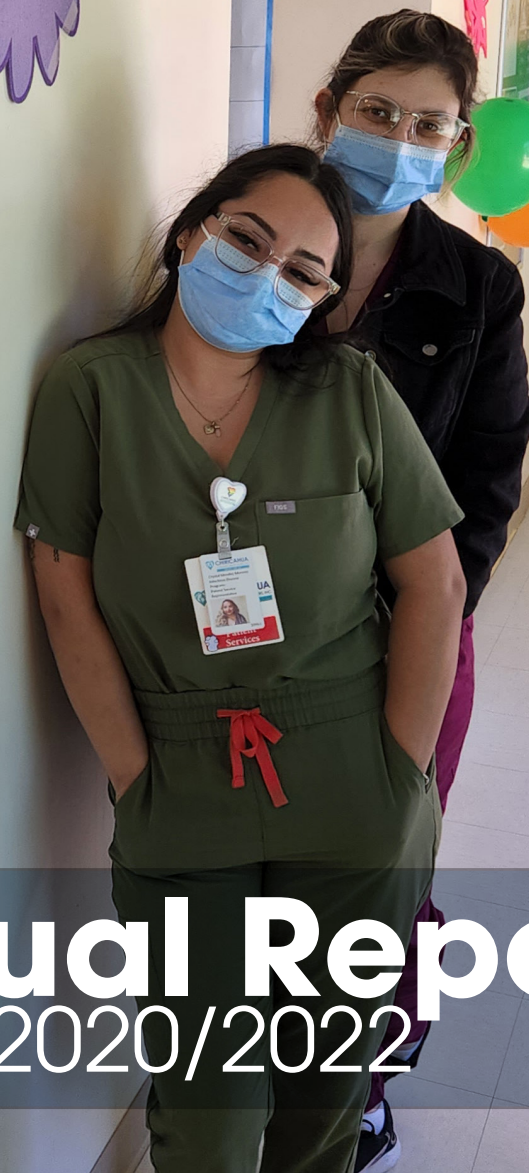

Annual Report

2020/2022

WHO WE ARE

Chiricahua Community Health Centers, Inc. (Chiricahua) is a mission driven Federally Qualified Health Center and a tax exempt not-for-profit 501(c)(3) organization. Founded in 1996 as a small, rural health clinic operating in a community center, Chiricahua has since grown to become the largest primary care organization in southeastern Arizona, serving more than 30,000 patients annually. Chiricahua operates fourteen fixed-site healthcare and pharmacy facilities along with seven mobile-medical and mobile-dental clinics, that serve patients throughout the more than 6200 square mile borderlands of Cochise County.



Chiricahua's First Healthcare Center - 1996

Table of Contents

Letter From the Board Chair & CEO	4
Board of Directors & Officers	5
Chiricahua by the Numbers	8
Overview	11
Chiricahua’s Pandemic Programming & Beyond	14
Other Business	17
New Leadership	18
Recognition	19
Chiricahua Cares	21
Moving Forward	23
Locations	24
Financial Statement	25
Donors & Partners.....	26



Letter From the Board Chair & CEO

March 2023

Dear Friends and Colleagues:

It is our pleasure to present to you the 2020/2022 Annual Report for Chiricahua Community Health Centers, Inc. This report chronicles our programming accomplishments from 2020 through December 2022, including our response to the COVID-19 pandemic. It further presents the most recent audited financials for fiscal years 2020/21 and 2021/22, ending April 2022.

As you read about our work, we ask that you reflect, as we did, back to March 2020, when life as we knew it was suspended. When life as we knew it became a life we no longer knew. When routine operations ceased across the country, offices closed, and public transportation ground to a halt. When hospitals and emergency rooms filled, and clinics around the country emptied. A time when no one wanted to go where people might be sick, except Chiricahua staff. At a time when many essential frontline healthcare workers were withdrawing, Chiricahua's team responded on multiple levels. Everyone played their role at the time of greatest need, and we are proud to say that Chiricahua **NEVER CLOSED**—not for one day.

In the time since March of 2020, we have learned how to live with COVID-19 and to fight it on every front. When vaccines became available, we offered them community by community, house by house,

and person by person; now, tens of thousands of vaccines have been delivered. We continue to be safe, to wear masks, and have emergency protocols in place for patients with COVID-19 infection or exposure. We never dropped our guard, as we continue to work together to coordinate with our counterparts in Mexico and Phoenix and to share data on COVID-19 outbreaks and other infectious diseases. We continue to follow the science, and while far too many lives were lost, Chiricahua continues to help countless women, men, and children thrive. **We believe that living a rural life should not mean living a shorter life.** As you will read, we have emerged from these past two years as a stronger organization, growing to better serve our patients and our community.

Under the banner of "**Health for All**" and guided by the values of caring, compassion, and respect, our 450-strong staff say with confidence that there are great things ahead for Chiricahua and Cochise County. We are proud of our work and we believe that if we work both smart and hard our organization can be exceptional. We look forward to your review and reflections on the accomplishments chronicled in this Annual Report.

With Gratitude,



Anita Baca,
Chair, Board of Directors

Jonathan Melk, MD FAAP
Chief Executive Officer

**Chiricahua Community Health
Centers, Inc.
Board of Directors**

Anita Baca, President

Carrie Gustavson, Vice President

George Cullinan, Secretary

Alvardo Montoya, Treasurer

Britt Hanson, Esq.

Joan C. Hansen, Lt Col, USAF (Ret)
Member at Large

Lourdes Fernandez

Ana Gonzales

Mignonne Hollis, MBA

Najayyah Many Horses

Mark Savage

Alma Vidosola

**Chiricahua Community Health Centers, Inc.
Officers**

Jonathan Melk, MD, FAAP

Chief Executive Officer

Jessica King, MBA

Chief of Staff

Darlene Melk, MD, FAAP

Chief Medical Officer

Randal Christensen, MD, MPH

Chief Clinical Information Officer

Dennis Walto, MA

Chief of External Affairs & Foundation Executive Director



"Our Square"

Chiricahua serves the 6,219 square miles of Cochise County, Arizona.

Our Services

Adult Medicine

Pharmacy

Behavioral Health

Pharmacy Delivery

Breastfeeding Support

Radiology

Case Management

Reproductive Health

Dental

Substance Use Treatment

Family Medicine

Teens and Young Adults

Financial Assistance

Telehealth

Geriatrics

Transportation

Laboratory Services

Vaccines

Mobile Health Care

Visiting Specialists

Nutrition Counseling

Outreach

WIC

Pediatrics

Arizona

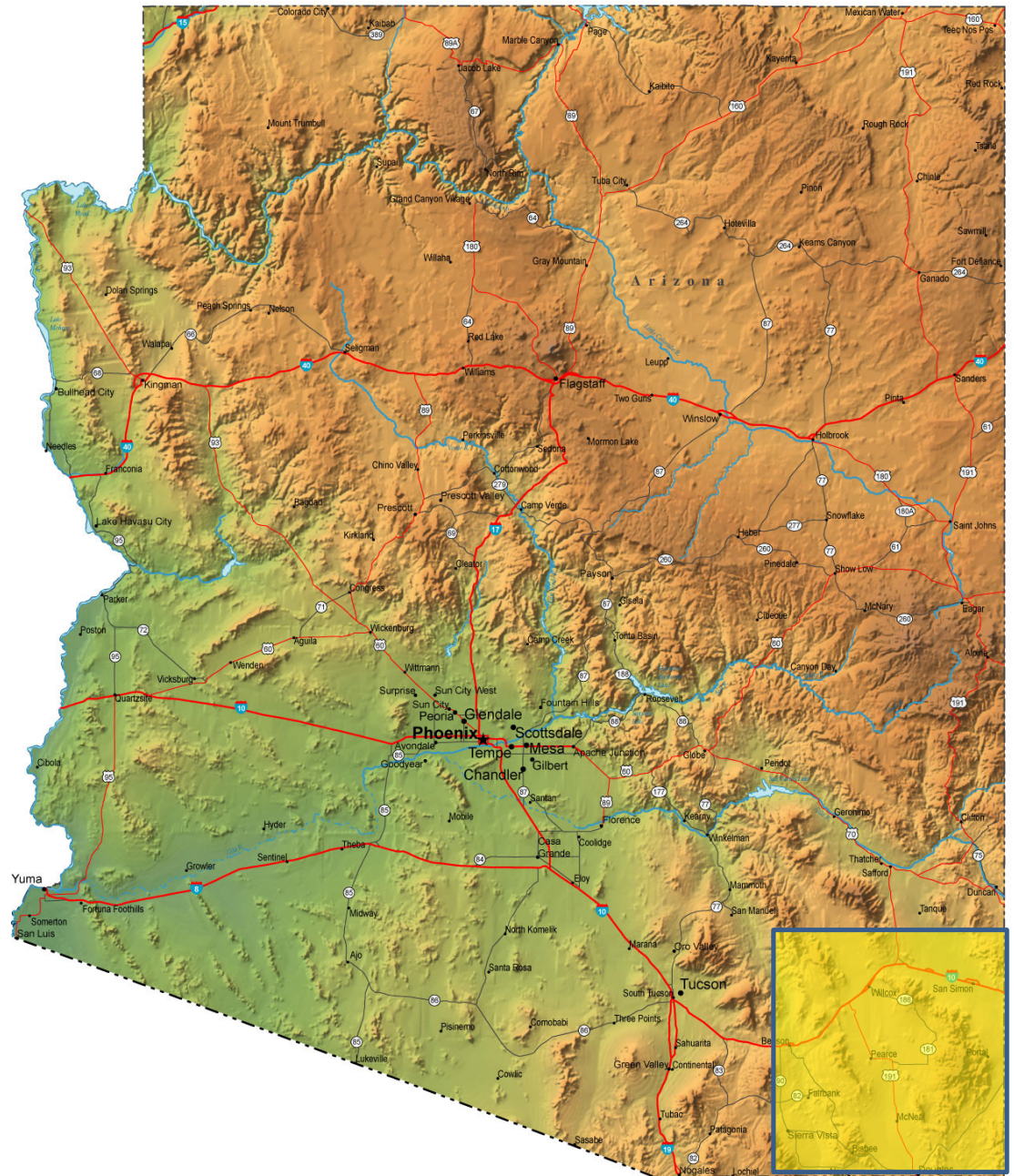

Chiricahua seeks to serve all of Cochise County through a network of “Brick & Mortar” and Mobile Clinics.

Cochise County

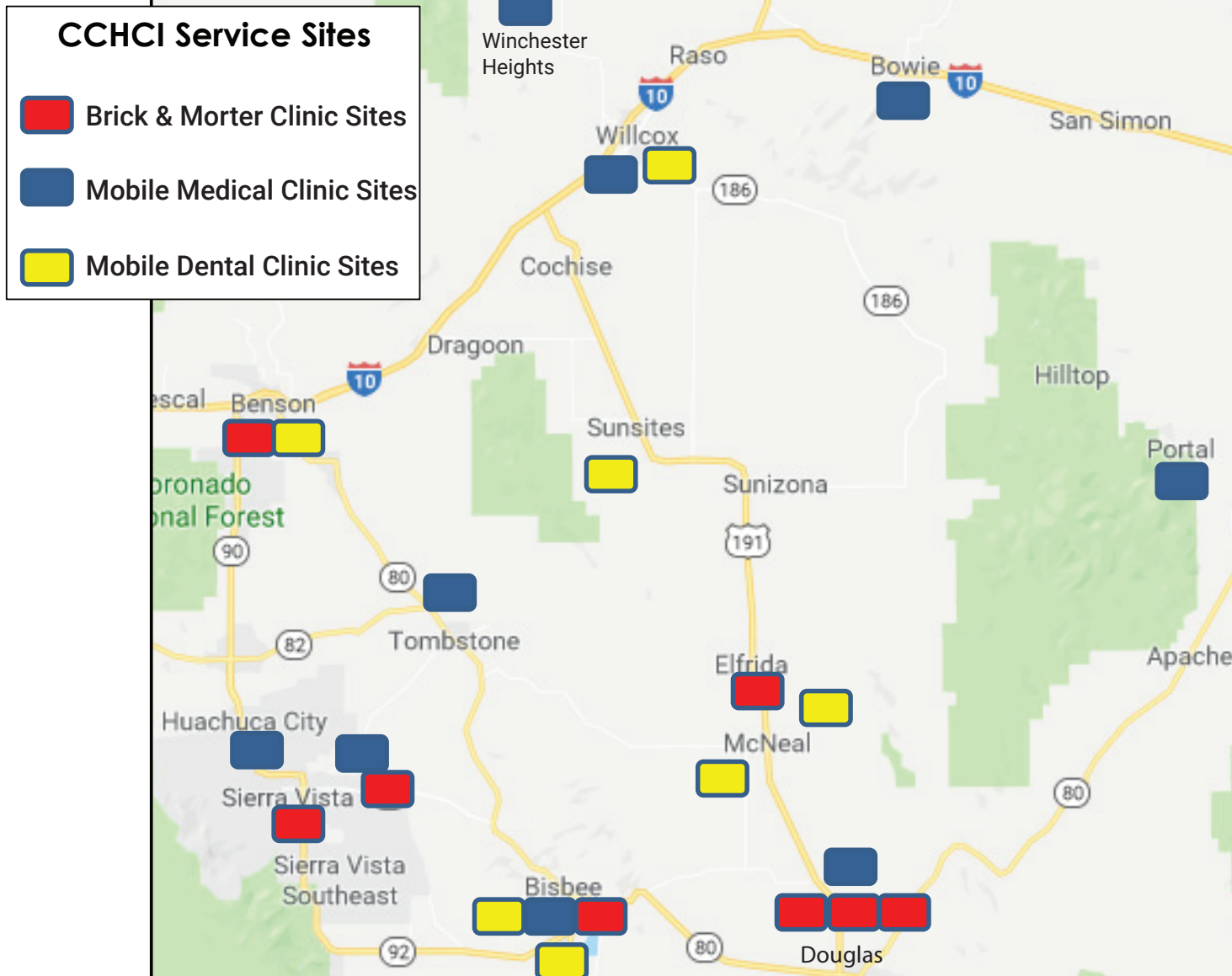

Chiricahua by the Numbers (2021)

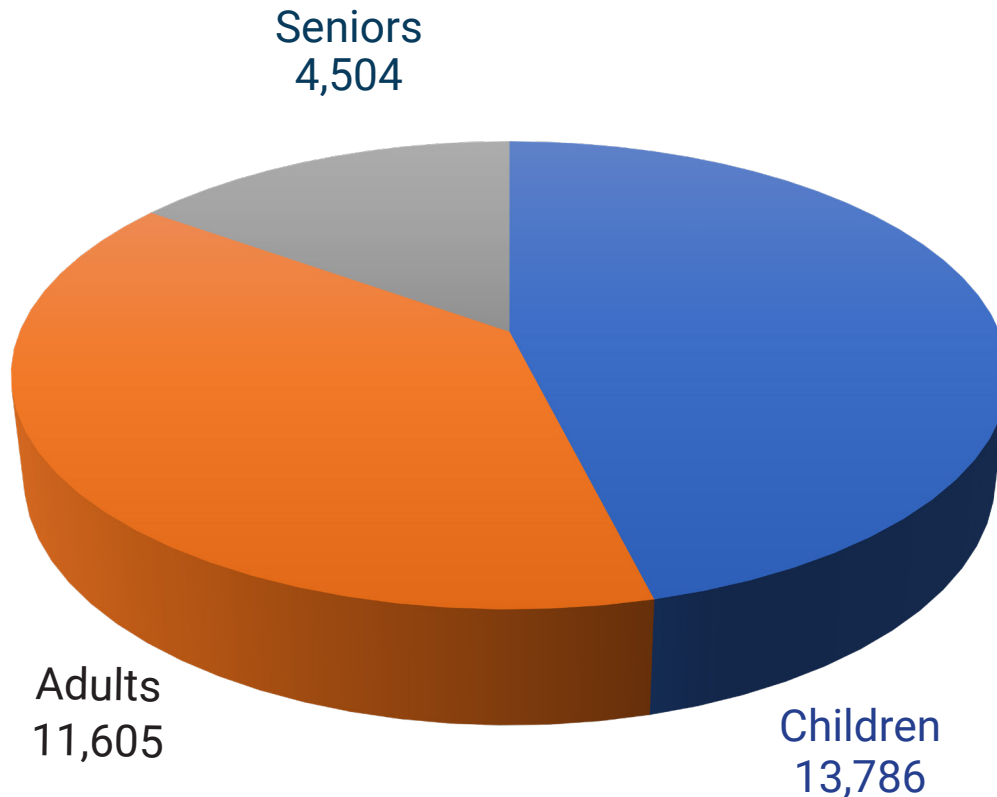

29,895 Patients Served

46% Children 0-17 years old

39% Adults 18-64 years old

15% Adults 65 years and older

2020/2021

223,575 Visits:

150,279 Medical

33,789 Dental

12,918 Mental Health

12,832 Nutrition, Physical
and Occupational Therapy

9,326 Case Management

4,431 Substance Use

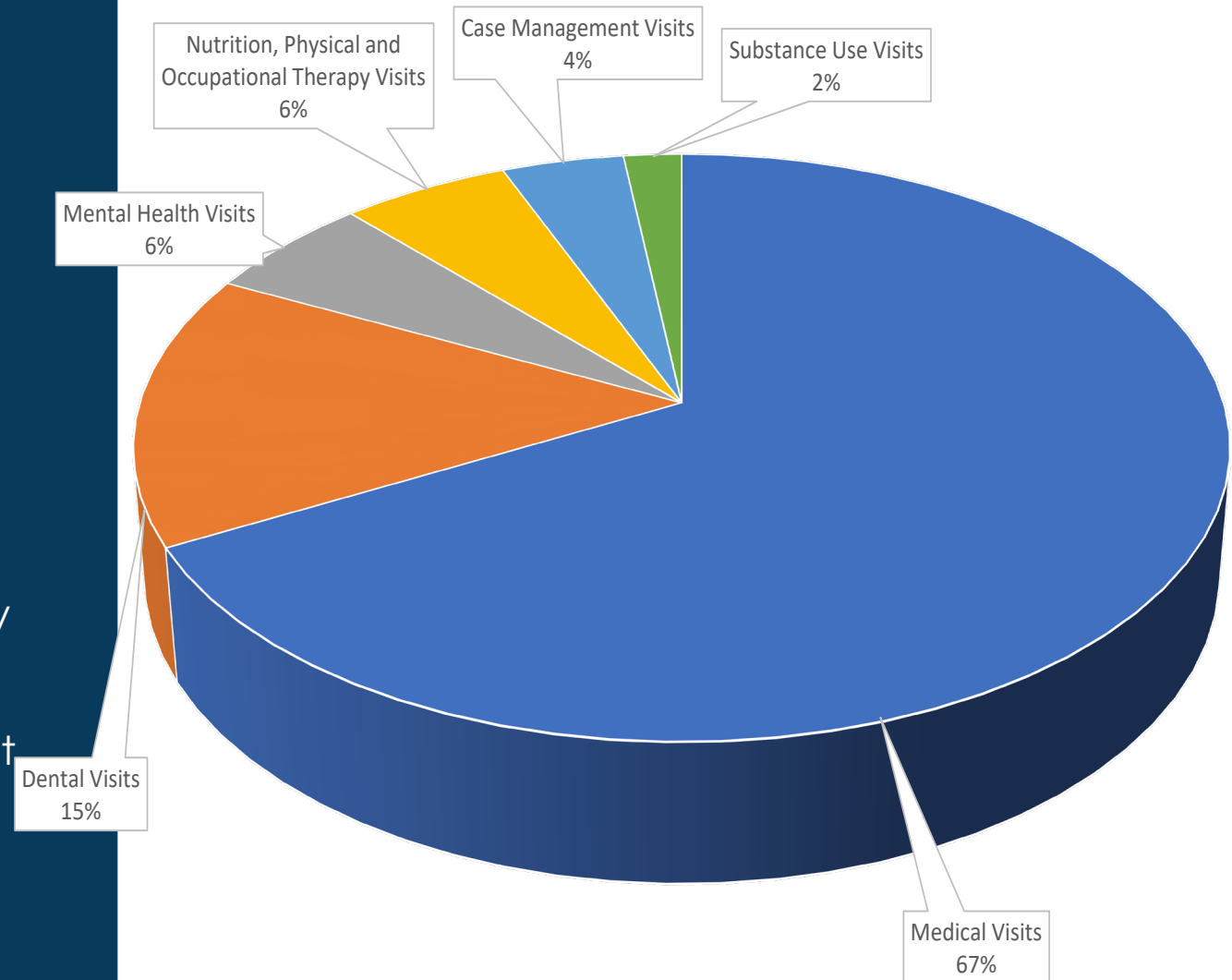

TELEHEALTH VISITS

2020 **42,930**

2021 **18,534***

Telehealth was not only instrumental in providing services safely during COVID-19, but also expanded access to healthcare for our rural communities where distance and transportation are barriers to access.

*As vaccines became available in 2021, the reliance on telehealth visits decreased.

In-Person vs Telehealth Visits 2020/2021

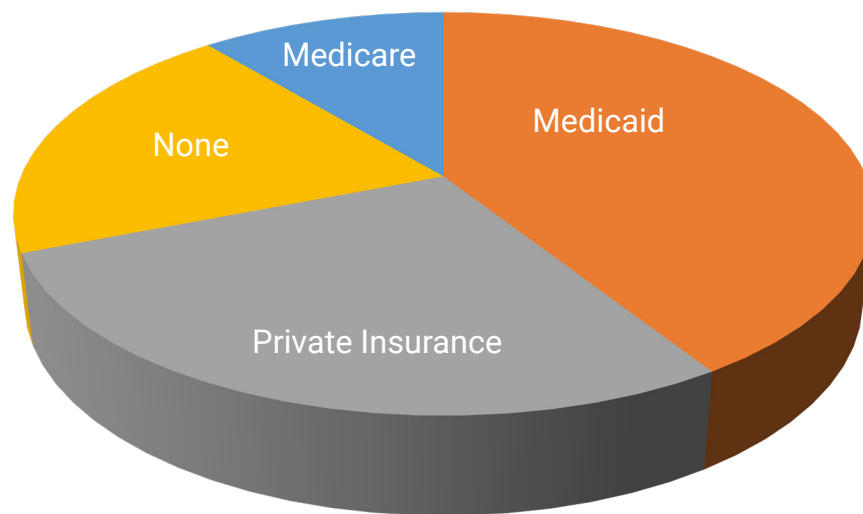
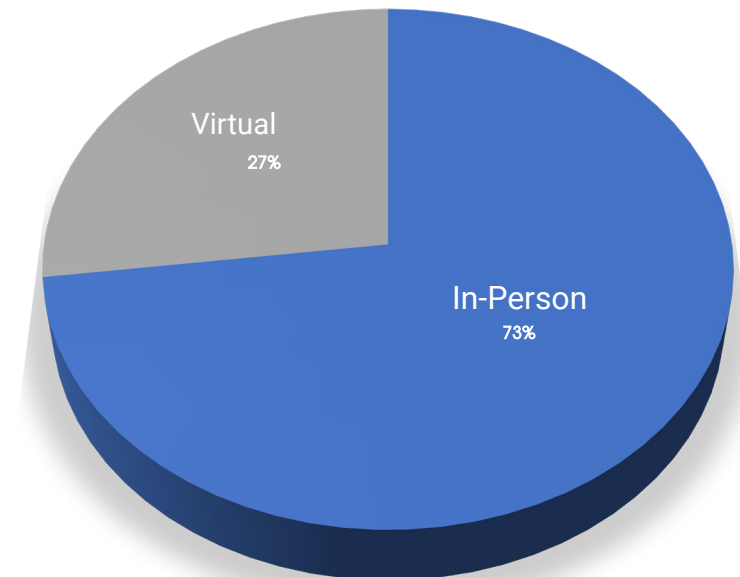

Medicaid **41%**

Private Insurance **28%**

None **20%**

Medicare **11%**

Overview

Against All Odds – Chiricahua Community Health Centers

Spanning more than 6,200 square miles and situated along 100 miles of the US-Mexico border in southern Arizona, Cochise County is more than just a setting for J.A. Jance novels. In many ways, it's a nation unto itself, covering an area bigger than Rhode Island and Connecticut combined and geographically larger than 80 countries.

This same geographic expanse, coupled with isolation and the prevalence of poverty, makes preventive and primary healthcare inherently complex. Cochise County has an active military post, remote ranches and farms, border towns, and historic mining communities. As such, Chiricahua must tailor its care for diverse populations, including migrant farm workers, retired copper miners, veterans, single parents and their children, recent immigrants, law enforcement, and residents of public housing.

Cochise County is a Health Professional Shortage Area for medical, mental health, and dental services, and higher rates of chronic illness, substance use disorders, and domestic violence incidents exist in our rural communities due to geographic isolation and limited job opportunities.

Chiricahua is the only Federally Qualified Health Center (FQHC) in the county. Our 450+ employees provide primary healthcare for all ages, including acute, chronic, and preventive medical care; behavioral health assessment, counseling, and treatment; comprehensive dental care; nutrition evaluation and education; psychiatry; and pharmacy, laboratory, and radiology services, all regardless of insurance, immigration status, medical condition, or ability to pay.

Demographics: Since 2015, Cochise County's population has aged, with the number of 65-year-old and older individuals growing by 4.8%. The demographic distribution of the county is 55% white, 36% Hispanic, 4% Black, 2% Asian, 2% Native American and Alaska

Native, and 1% Native Hawaiian and other Pacific Islander. About half the population lives in either Sierra Vista or Douglas. Twenty-one percent of the county's children live below the federal poverty threshold.

21% of the county's children live below the federal poverty threshold.

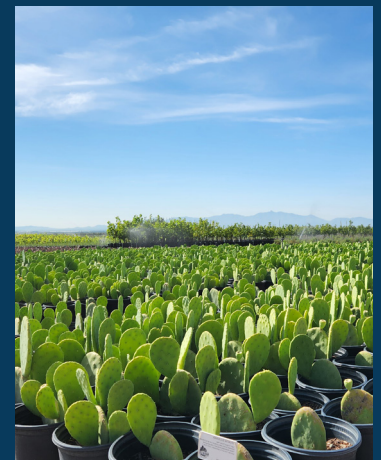
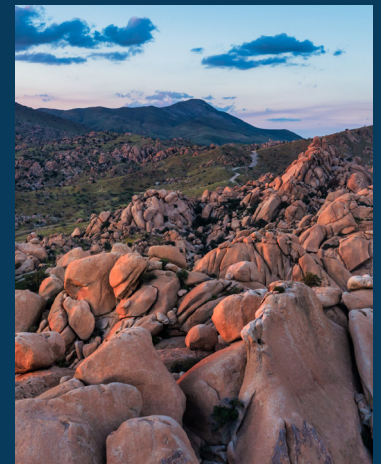
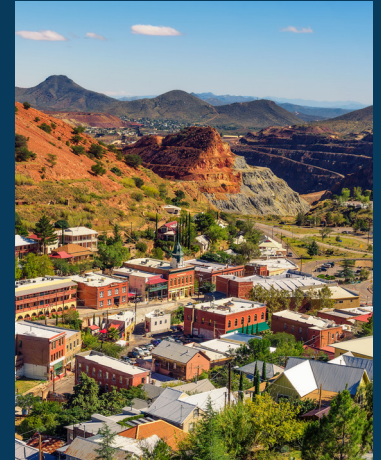

MEDICAL WORKFORCE

One indicator of healthcare access is the number of healthcare providers who are available to care for the population. The chart on the right illustrates the number of patients per primary care physician in Cochise County.

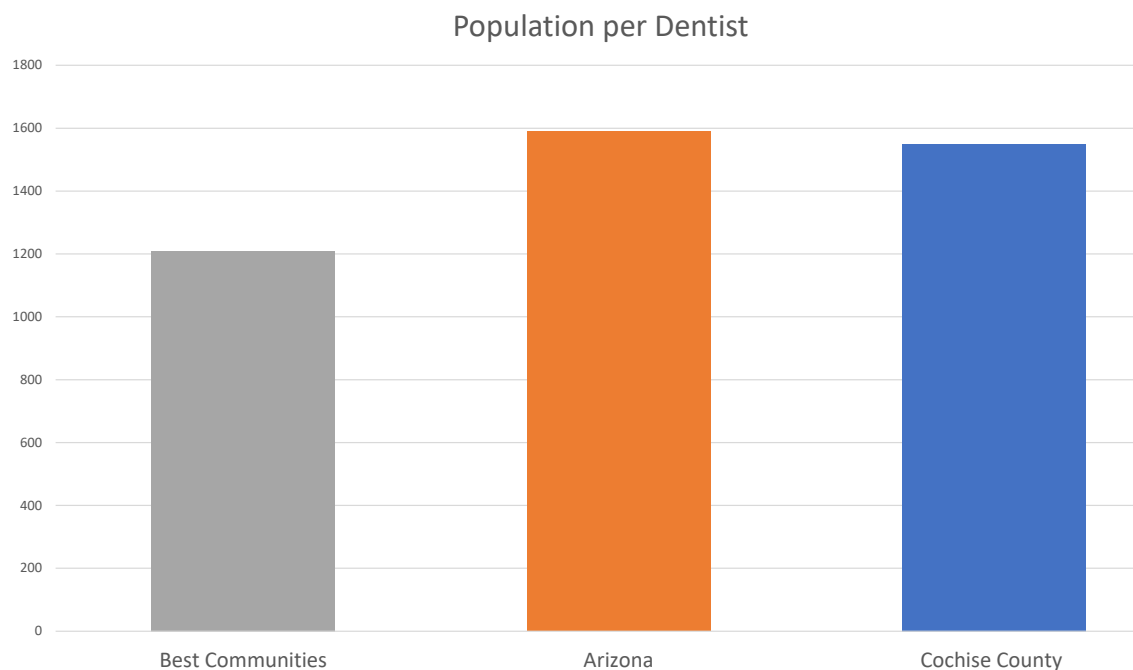
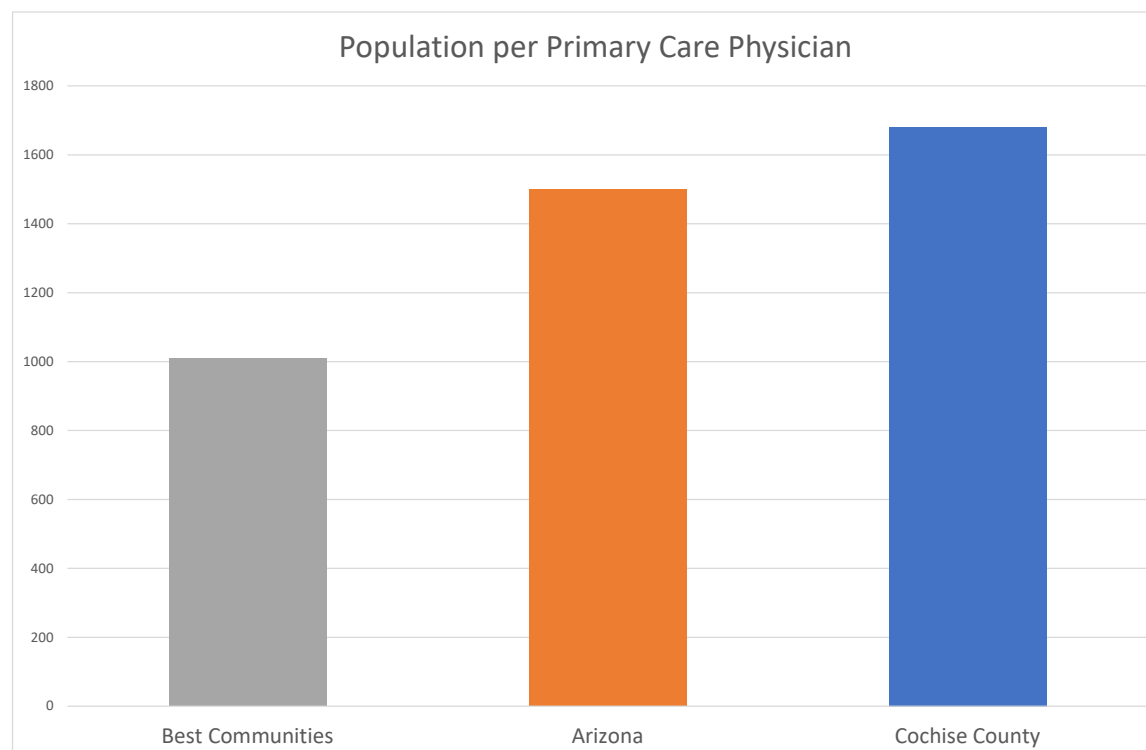

DENTAL WORKFORCE

In the top percentile counties, there is one dentist for every 1,210 people. In Arizona, the ratio is 1 for 1,590 individuals, with Cochise County being slightly more accessible with a ratio of 1 for 1,550. This favorable statistic is in part due to Chiricahua's dental program growth.

BEHAVIORAL HEALTH WORKFORCE

Data for mental health states that, ideally, there would be one mental health professional to care for 250 people. In Arizona, that ratio is 1 to 660 individuals, and in Cochise County, one mental health provider is available for every 820 individuals.

Population per Mental Health Provider

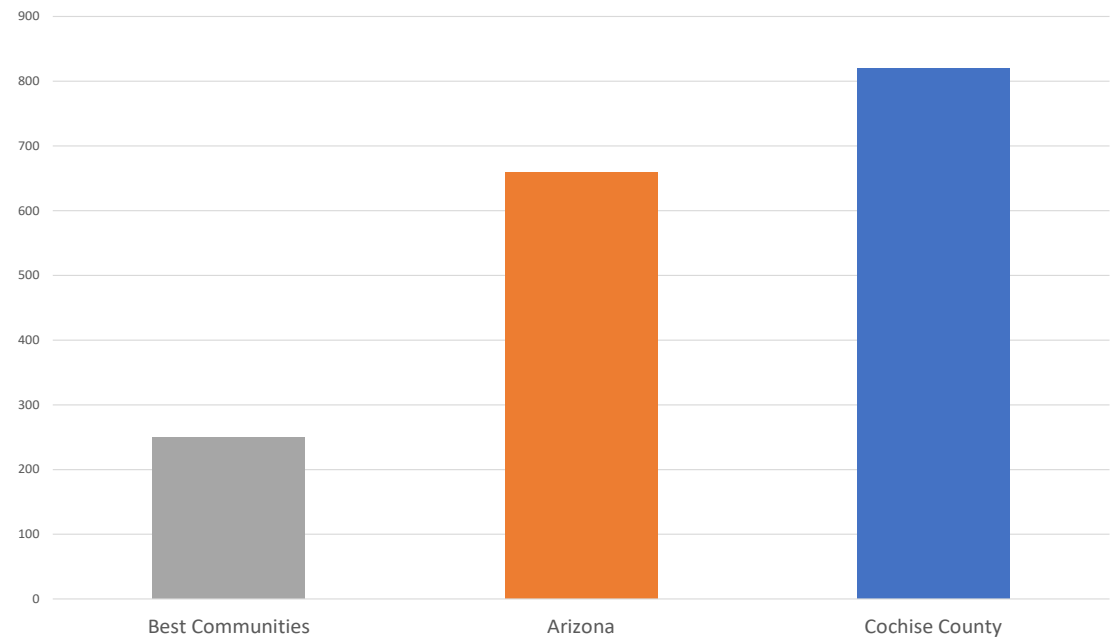

Drug Overdose Mortality Rates (per 100,000)

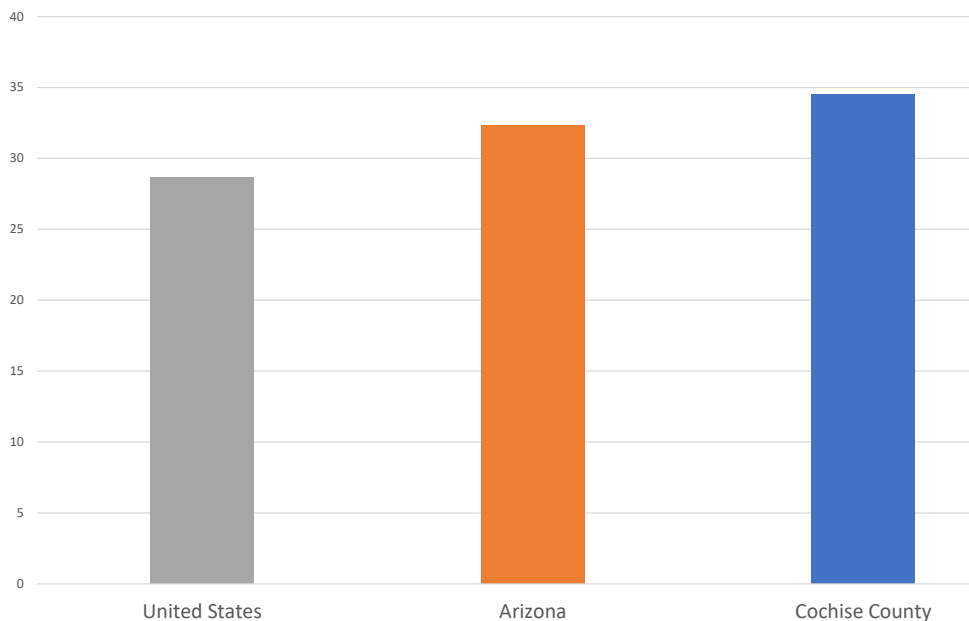

BEHAVIORAL HEALTH CHALLENGES

Cochise County struggles with elevated rates of behavioral health issues. The chart on the left shows that drug overdose mortality rates were higher in Cochise County than in Arizona or the US.

Chiricahua's Pandemic Programming & Beyond

Fighting COVID-19 on Every Front

March 2020 – We all remember... When life as we knew it became a life we no longer knew. Routine operations ceased across the country; offices closed, and public transportation ground to a halt. Hospitals and emergency rooms filled; clinics emptied. No one wanted to go where people might be sick. Except for Chiricahua staff. As an essential front-line healthcare agency, Chiricahua's team responded on every front.

Business as usual became business unusual. Chiricahua rapidly expanded telehealth programming.

Our mobile medical clinics were parked outside our medical buildings, providing a safe place for parents to bring healthy children under five for immunizations, laboratory testing, and assessments. After several months, the services were expanded to include vaccines for patients under 18 years old, adolescent check-ups, and pediatric care for those without video capability for telehealth services.



The Centers for Disease Control and Prevention, as well as other researchers, reported a national decline in childhood vaccination rates between 2019 and 2020, ranging from 6.7% to 30% depending on the age group and specific vaccine. Chiricahua's innovative, "clean" mobile clinics helped boost vaccine rates by 9% between August 2019 and August 2020, with an additional increase of 5.5% by June 2021.





Chiricahua also used mobile clinics for COVID-19 screening, testing, education, outreach, and vaccination. Together with our clinics and other outreach efforts, Chiricahua provided 46,908 COVID-19 vaccines and 38,734 COVID-19 tests.

Chiricahua received one of 11 Innovation Awards in Community Health from Direct Relief and the Pfizer Foundation to create a “Borderlands Infectious Disease Prevention Program.” The funding was used to increase collaboration between Mexican and US public health officials to improve outcomes and address health inequities in rural and under-resourced communities. Telehealth services improved staff and patient safety while ensuring that patient care was continuous and coordinated. Community outreach workers created trust, addressed stigma, and dispelled misperceptions about COVID-19 infections and vaccines. They shared

data surveillance across the border helping medical providers in Agua Prieta, Mexico, and Cochise County to track and then treat infectious diseases like tuberculosis, chlamydia, as well as COVID-19.

Chiricahua is one of the first healthcare providers in the US to adopt technology that allows the rapid diagnosis of common sexually transmitted infections. This means that patients do not have to wait days for test results. The work is a partnership with The Body Agency Collective and Visby Medical, Inc. The Sexual Health Click Test can identify gonorrhea (GC), chlamydia, and trichomoniasis (trich). Sexually transmitted infections have increased dramatically since 2009 in Cochise County.

Mobile clinics are also expanding medical services within the county. In 2022, weekly medical services began in Portal, Arizona.

In 2021, **Chiricahua** was proud to open a state-of-the-art Family Dental Center located at the Ginger Ryan Clinic in Douglas. The clinic has seven dental operators and a panoramic x-ray machine, purchased with support from the Douglas Industrial Development Authority. Federal COVID-19 funds were used to expand the medical clinic and create the new dental space.





Chiricahua's Dental Program had the highest rate (95.2%) of dental sealants in Arizona for patients aged 6-9 years old who have been diagnosed with a moderate to high risk for dental caries.



Integrated Behavioral Health is a proven efficient way for behavioral health providers to work with the medical team to help patients manage their medical conditions. Chiricahua knows that healthy behaviors are not easy, social factors have a profound impact on health, and mental health and well-being are intertwined. Our business is to take care of the whole person using a team of knowledgeable, compassionate professionals. The pandemic reiterated those facts and redoubled our commitment to addressing health-related social needs.

The pandemic led to increased substance use nationally and coincided with a stark increase in overdose deaths in Cochise County. In response, Chiricahua dedicated significant resources to its medication-assisted treatment program and began to offer psychiatry services. The treatment program, supported by funding from Cochise County includes case management, counseling, and medication for opioid and alcohol addiction.



Home delivery from Chiricahua's pharmacies began during the pandemic's peak but has proved so successful that it will be a permanent offering. The program helped a patient with diabetes who depended on her son to get her insulin. Her son's work schedule meant that the patient was going to miss several doses of medication. Home delivery prevented missed doses and an almost certain poor outcome. Home delivery allowed a mother, her newborn, and her grandparents to stay at home and not chance exposure to COVID-19 or other infections.

Other Business

Bisbee Healthworker Training Center

A congressional appropriation for a training center in Bisbee will renovate space adjacent to the Bisbee pharmacy into a multi-use training and meeting space. Chiricahua will use the training center to prepare healthcare workers to address and solve rural healthcare challenges for the benefit of Cochise County.



Domestic Violence Programing

The Diane and Bruce Halle Foundation will support the expanded services of Chiricahua's Domestic Violence and Sexual Assault Program. The team will offer education in middle and high schools throughout the county. Their curriculum will create awareness of domestic violence and promote healthy, safe relationships through discussions of self-care, boundaries, communication, and how to help someone in an unsafe relationship



Bisbee Healthworker Training Center

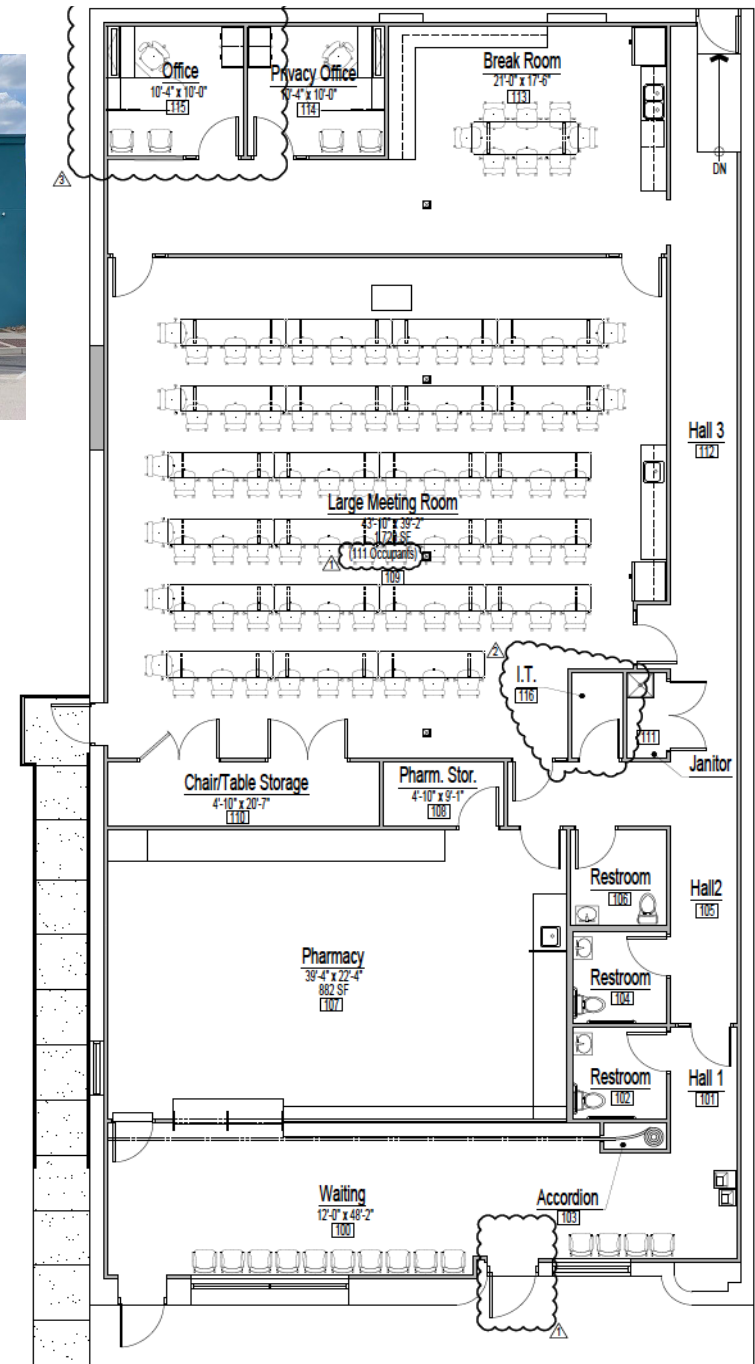

New Leadership

Chiricahua expanded the leadership team during the pandemic.

Darlene Melk, MD FAAP, CPE, was promoted to the position of Chief Medical Officer in 2020.

Randal Christensen, MD, MPH, joined as Chief Clinical Information Officer in 2021. Dr. Christensen is not only responsible for health information but also for patient safety, quality, and risk management.

Dennis Walto, MA, the Chief of External Affairs, was hired in 2022 and is charged with developing a charitable foundation, increasing private revenue, and leading policy and advocacy efforts.

Jessica King, MBA, assumed the role of Chief of Staff and oversees human resources, staff development, and administration.

We believe in providing our employees with opportunity for professional growth and development.

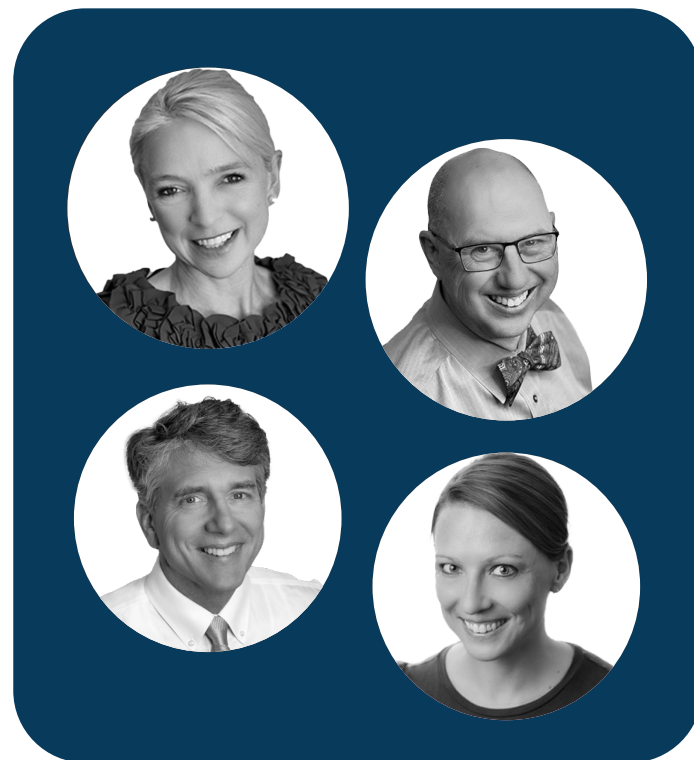

Chiricahua Recognition

Visit of US Assistant Secretary of Health Admiral Rachel Levine, MD

In December 2022, Chiricahua hosted Dr. Rachel Levine and Jessica Marcella, MPH, Director of the Office of Adolescent Health, at the US Department of Health and Human Services, to our clinics in Bisbee and Douglas. Prominent on the agenda was discussion of expanded Title X funding and more resources for youth health services.





In June 2022, Chiricahua was notified we were one of the winners of the “MOST INNOVATIVE MOBILE PROGRAM IN THE COUNTRY!” The competition was sponsored by the National Association of Community Health Centers (NACHC) and the Lowenstein Family Foundation. The recognition came with a \$10,000 prize!



Chiricahua is proud that the National Organization of State Offices of Rural Health (NOSORH) selected Dr. Darlene Melk, Chief Medical Officer, as their 2021 Community Star, representing the state of Arizona. And that the Children's Health Fund presented Dr. Jonathan Melk, CEO, and Dr. Darlene Melk with the Irwin Redlener Founder's Award for Innovation and Advocacy.

Chiricahua was awarded a 4-star rating and a 100% score on Charity Navigator, as well as being elevated to Platinum status on GuideStar and Candid!



Binational Programming

Chiricahua's binational programming and work with seasonal and migrant farmworkers received widespread attention when it was featured in the El Paso Times in March 2022 and subsequently picked up by Gannett News Service, which owns over 100 daily newspapers and almost 1,000 weekly newspapers. In Arizona, the story was published in the Tucson Sentinel and on Arizona Central, a statewide online news outlet. The Spanish version of the story was also published and distributed by Gannett. The printed edition was published in April 2022.

Innovation

Chiricahua reviewed the immunization records of 931 two- and three-year old children seen in the dental clinics. Only 69% of them had up-to-date immunizations. The staff then surveyed parents about their willingness to vaccinate themselves or their child during a dental visit. More than half said yes. Support from the Diane and Bruce Halle Foundation, in addition to funding from Delta Dental, will allow a vaccine nurse to join the dental team to efficiently and effectively offer vaccines to busy parents, answer questions, and increase the number of children in the county who have up-to-date immunizations. We are offering this innovative service in our Douglas and Sierra Vista clinics.



Chiricahua Cares

The Chiricahua Cares Fund is a safety net pool of financial resources that exists to remove barriers to health and well-being for patients in need. A full 100% of funds received by the **Chiricahua Cares Fund** are dedicated to patients. With small amounts of donated money, Chiricahua Cares quickly bridges care gaps for hundreds of our patients most in need. Common interventions include assistance with medication copays, specialist visit, or an urgent diagnostic study. With the help of **Chiricahua Cares**, we get the electricity back on at a family's home, help with travel costs, or ensure a family has adequate clothing after a house fire.

Case Study: Felix Bravo, or “Don” Bravo as he is known to everyone in his tight-knit Arizona community, is a survivor. He lives in a settlement known as Winchester Heights in Cochise County. Winchester Heights is an important part of Arizona’s robust agricultural industry (more than \$23.5 billion in products like avocados, tomatoes, and chili seeds are grown there and exported to more than 70 countries around the world). At the heart of this industry are seasonal agricultural workers – laborers and their families who live in manufactured homes and trailers along dirt roads where children ride bikes and play soccer. In his late 90s, Mr. Bravo is one of those workers, and he has spent his entire working life in the sunbaked fields of southeastern Arizona. Like so many others in the community, he depends on Chiricahua for his medical needs. Indeed, without Chiricahua’s mobile medical clinic, parked at the



Winchester Heights community center every Wednesday, even routine healthcare would be a 2-hour drive away.

Recently, Mr. Bravo sat with a group of patients, co-workers, and friends who had gathered to wish his Chiricahua nurse practitioner a happy retirement. And he had a story to tell. There was a hush as he told the group how five years ago he had a life-threatening heart disease. The cardiac surgeon determined that he was too old to undergo surgery, but his nurse practitioner disagreed and finally convinced the surgeon to change his mind. Mr. Bravo explained that she wouldn’t take no for an answer, eliciting laughter because everyone knew her tenacious spirit. Mr. Bravo credits her with saving his life. In short, the care she provided to his family and community is priceless. Over the years she has also raised private funds to help Mr. Bravo’s family with the cost of his heart medicines and to purchase a heater for their home.

Mr. Bravo told how a special nurse practitioner took on a Tucson surgeon and changed not only the course of his treatment but also the rest of life. More than five years have passed since his life-saving heart surgery and though he’s sad to see his nurse practitioner retire, in his long life he’s learned that there is a season for everything. With Chiricahua’s help, Don Bravo’s growing season has been extended.



Case Study: Meeting Patients Where They Are.

Imagine a house, on the top of a mountain, in the middle of the Arizona desert. Now imagine being a community health worker, knowing that there's a patient in that house, in desperate need of medical care. What would you do? Well, for a Chiricahua community health worker, there was only one solution – climb up the mountain. He found an 84-year-old patient who was homebound. Equipped with a blood pressure cuff, an oxygen tank, and a laptop he contacted her medical provider, translated and explained the recommendations, and answered her questions. And then he went back down the mountain to see his next patient. He reflected that an important part of his job was to meet patients where they are (both literally and figuratively).

We believe that living a rural life should not mean living a shorter life.

Case Study: Farmworkers. A group of seasonal farmworkers asked Chiricahua to come to them to provide COVID-19 vaccines. Farmworkers work very long days, from early in the morning until late into the night. They do not have time to travel to the health clinics. They work, Monday thru Saturday and sometimes Sundays. Many do not have transportation. Chiricahua staff were excited to bring the mobile medical and dental clinics to the farm. They offered COVID-19 vaccines and tests, flu vaccines, blood pressure and diabetes screenings, and follow-up services. The farmworkers helped create a promotional video to support COVID-19 vaccine efforts among their peers.



The Giving Gala for Chiricahua Cares was held in 2022. The total amount raised exceeded \$60,000 making it the most successful Giving Gala EVER. Proceeds from this event surpassed all previous Gala fundraising totals combined! Thank You to all our sponsors especially our underwriter Vast Real Estate Solutions.

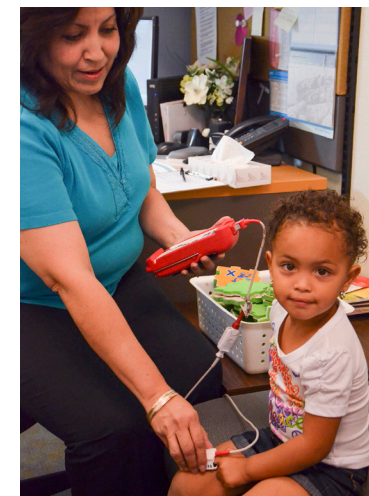

MOVING FORWARD

Willcox Health Clinic

The greater Willcox community has a population of approximately 9,000 individuals, with 30% of households classified as low-income and half of those households living below the federal poverty threshold.

Since 2003, the Willcox-area communities have been served by Chiricahua's mobile medical and dental clinics. The closest Chiricahua fixed-site clinic was initially 45 miles away in Elfrida and more recently, with the new clinic in Benson, 35 miles away.

In 2019, after demonstrating significant unmet healthcare needs, Chiricahua received approval from the Health Resources and Services Administration to establish a clinic in Willcox. Funding from the Del E. Webb Foundation will support a modular clinic to open in 2023, paving the way for service expansion.

Chiricahua Health Foundation

Through the leadership and support of the Chiricahua Community Health Centers, Inc. Board of Directors, the Chiricahua Health Foundation was registered as an Arizona Non-Profit Corporation on September 29, 2022. The Chiricahua Health Foundation's purpose is to raise support for programs, services to patients, and capital needs of Chiricahua. The vision is to Eliminate Health Disparities, and the Mission is to support Chiricahua in caring for patients and building healthy communities. The Foundation will officially launch in late 2023.

Floor Plan for Del E. Webb Foundation Supported Modular Clinic.



Mobile Mammography Clinic

With the support of a Congressionally Directed grant of \$983,000, Chiricahua will soon be delivering mammograms to women throughout Cochise County. Funding was approved in the 2022/23 federal budget and services are slated to begin early 2024.

Locations

Chiricahua Community Health Centers, Inc. has sites all over Cochise County to serve families and individuals of all ages.

Benson Family Health Center and Pharmacy

335 S. Ocotillo Avenue, Benson

Bisbee Family Health Center

108 Arizona Street, Bisbee

Bisbee Infectious Disease Program

310 Arizona Street, Bisbee

Bisbee Pharmacy

107 Arizona Street, Bisbee

Douglas High School Student Clinic

1550 15th Street, Douglas

Early Childhood Center of Excellence

1151 16th Street, Douglas

Ginger Ryan Clinic

1100 F Avenue, Douglas

Pediatric Center of Excellence

815 15th Street, Douglas

Douglas Pharmacy

1111 F Avenue, Douglas

Cliff Whetten Clinic

10566 North Highway 191, Elfrida

Portal Mobile Medical Clinic

1216 West Portal Road, Portal



Buena High School Student Clinic

5225 East Buena School Boulevard, Sierra Vista

Sierra Vista Adult Clinic, Family Dental Center, Pediatric Clinic, and Pharmacy

155 Calle Portal, Sierra Vista

Chiricahua at SEABHS

4755 Campus Drive, Sierra Vista

Willcox Mobile Medical Clinic

1140 West Fremont Street, Willcox

Sierra Vista Behavioral Health Center

77 Calle Portal, Suite C-240, Sierra Vista

Financial Statement

Revenue	2020/2021	2021/2022
Patient Revenue (Includes Medicaid, Medicare, Private Insurance, and Self-Pay Patients)	\$30,740,034	\$37,952,258
Federal Grants	11,450,259	12,466,321
Other Grants	1,032,309	1,918,312
In-Kind Contributions	1,175,471	1,494,868
Total Revenue and Public Support	\$44,398,073	\$53,831,759
Expenses		
Direct Patient Services	28,835,467	34,478,021
General and Admin	6,687,095	7,562,478
Depreciation	1,367,581	1,365,405
Interest	170,873	166,421
In-Kind Expense	1,175,471	1,494,868
Total Expenses	\$38,236,487	\$45,067,193
Total Increase in Net Assets		
Excess of Revenue and Public Support Over Expenses	\$6,161,586	\$8,764,566
Total Increase in Net Assets	\$5,514,306	\$8,553,171
Total Uncompensated Charity Care	\$549,054	\$544,522
Total Ending Net Assets	\$15,731,155	\$24,284,326

Donors & Partners

05/2020 - 12/31/2022

\$1,000,000 and over

Affirm Sexual and Reproductive Health for All
Cochise County
US Department of Health and Human Services

\$500,000-\$999,999

Arizona Alliance for Community Health Centers
Arizona Department of Health Services

\$250,000-\$499,999

Children's Health Fund
Del E. Webb Foundation
Direct Relief
First Things First
Legacy Foundation of Southeast Arizona

\$100,000-\$249,999

Diane and Bruce Halle Foundation
Ronald McDonald House Charities

\$50,000-\$99,999

Blue Cross Blue Shield of Arizona Foundation for Community & Health Advancement
United Way of Southern Arizona
City of Douglas

\$25,000-\$49,999

Arizona Community Foundation
Copper Queen Community Hospital
Delta Dental Foundation
TMC Foundation
Visby Medical
Vitamin Angels

\$10,000-\$24,999

American Southwest Credit Union
Arizona Community Health Workers Association

Arizona G&T Cooperative/Sulfur Springs Valley Electric Cooperative, Inc.

Benson Hospital
Douglas Industrial Development Authority

El Rio Community Health Center
National Association of Community Health Centers

National Emphysema Foundation

UMR Healthcare
Vast Real Estate Solutions

\$5,000-\$9,999

AAS Holdings, LLC
Bank of America
Freeport McMoRan, Inc.
Mutual Of America

\$800-\$4,999

Joselita Abeleda
Anonymous
Arizona Complete Health
Anita Baca

Victoria Brand

Patti and Bill Bruno
The Body Agency

Canyon Vista Medical Center

Randal Christensen

CoveredMeds
Elizabeth Fabry

Fadi Fahad

Intellichart

Fester & Chapman, PC

William Garmire

Amanda Greer

Carrie Gustavson

Joan Hansen

Haven Health Douglas

Pierre Hollis

Kerstin Hurley

Ursula Hurley

Andrew Jacob

Lisa Johnson

Labcorp

Lovitt & Touché, a Marsh & McLennan Agency

Eduardo Marrero Velis

Meghan McGarrity

Medicus IT
Jonathan and Darlene Melk

Northern Cochise Community Hospital, Inc.

Linda Peck

Robert Quintanar

Kimberly Riggs

Hadi Safavi

Mark Savage

Clement Scott

Sierra Vista Rotary Club

Sonora Quest Laboratories

Susan Heinlen Spalding

Keith Stanford

Katrina Ventura-Morano

Jane Williamson-Davenport

\$400-\$799

Adobe

Alicia Chaouchi

George Cullinan

Fidelity Charitable

First American
Equipment Finance

Mark Farr

Amy Gerber

Suzanne Gilbert

Don Herrington

Susan Hicks

Theresa Kibler

Rita Kilgore

James McEntee

Michael McGinnis

Shaun and Yanna Phillips

Claudia Pleitez Tecun

Victor Romero

Nori Ruo

Dennis and Donnette Hill
Walto

Mark Woods

\$1-\$399

Catherine Abernathy

Robert Bruce Akin

Hilary Allen

Summer Anderschott

Michael Arzate

Karina Bechtold

Janis Bell and David
Puppel

Paula Bird

John Blackburn

Darren Bush

Cynthia Cartwright

Brianna Catlet

Sarah Colwell

Christy Conlan

Anthony Corron

Susan Cruz

Amy De Schepper

Lisa Deese

Janice Evelyn Dowell

Daniel Driscoll

Erin Eastmead

Mayra Escarcega

Ana Gonzales

Katie Fahad

Mary Fairbanks

Patricia Fleming

Lourdes Fernandez

Mary Gomez

Christine Grassman

Dan Green

Jill Green

William Green

Christiana Hargis

Britt Hanson

Emily Harris

Paul Hendricks

Mignonne Hollis

Jeffrey Holzberg

Joshua Jean

Mike Judd

Jessica King

Minerva Kong

Helen Marie Kupeli

Natasha Kyles

Daniel Lake

Lilia Lara

Romina Leon

James Lewis

Sergio Luis Lopez

Jocelyn Luna

Najayyah Many Horses

Carter Mayberry

William McGuire

Gary McPherran

Patrick McPherran

Randy Miller

Jane Montgomery

Alvardo Montoya

Samantha Morehouse

Estivaly Moreno

Carey Morris

Lowell Neff

Victoria Ochoa

Pamela Oliphant

Adriana Ortiz

Juanita Paet Desilva

Dale Parry

Flavio Peralta

Kayla Percy

Donald and Eloisa Reay

Todd Reihing

David Rennie

James Reynolds

Susan Rich

Kimberly Riggs

Colleen J. Riley

Anthony Romeo

Amy Salazar

Cheri Sanchez

Kirby Schimmels

John W. Shanabrook

Constance Sharp

Elizabeth Stoner

Damian Telencio

Devyn Thurber

Brittney Trang

Rebecca Travis

Peter and Judith Van
Cleve

Yulemi Velazco

Alma Vildosola

Juan Pablo Villalobos

Catherine Vitale

Wendy Vrooman

Deborah Walk

Levi Walker

Mark Wallis

Eva Weintraub

Wallace Wendeborn

Evelyn Whitmer

Diane Wimmer

Jessica Yanow



CHIRICAHUA

COMMUNITY HEALTH CENTERS, INC.

HEALTH FOR ALL

CCHCI.ORG



520-364-1429



cchci@cchci.org



/chiricahuacommunityhealthcenters



@chiricahuacommunityhealth



@CCHCI1